



INFORMATION REGARDING SWIMMING POOLS

(File 4410-10 Dated September 2008)

Including in-ground, above-ground and inflatable swimming pools.

Swimming Pool Safety

There are some dangers associated with home swimming pools, especially for young children. The pool should be fenced and the pool area separated from the dwelling.

Children should be supervised at all times they are using the pool and pool area.

Pools fitted with a skimmer box or an in-floor cleaning system should have secure lids and covers to prevent access by children and prevent a child's hair or clothing being sucked into the system.

Electrical fittings such as pumps, lights and electric cords must be well maintained and kept free of damage.

The NSW Department of Fair Trading provides consumer advice. Refer to publications on www.fairtrading.nsw.gov.au

Is Development Consent required to install / construct a swimming pool?

If the swimming pool is capable of being filled with 300mm or more water depth, Council approval is necessary before any work is carried out. This depth of water is the criteria where the installation is defined as a swimming pool in the *Swimming Pools Act 1992*

This applies to in-ground, above-ground and inflatable swimming pools.

It is also a requirement for a Construction Certificate (CC) to be submitted in conjunction with a Development Application (DA). If the capacity of the pool is more than 40,000L a BASIX Certificate is required (see www.basix.nsw.gov.au/information/alts_adds).

Fencing Requirements.

Where a swimming pool requires Council approval, the pool area must be fenced and separated from the dwelling. The fencing requirements are contained in the *Swimming Pools Act 1992*, and *Swimming Pools Regulation 2008* http://www.austlii.edu.au/au/legis/nsw/consol_act/spa1992192/ and the fence and gates construction standard is contained in Australian Standard AS1926.1 – 2007. For purchase of this document see, www.saiglobal.com/shop/

An extract from the *Swimming Pools Act 1992* showing fencing locations is shown overleaf.

How to Lodge a Development Application (DA) with Council.

Council requirements for lodging a DA can be found on Councils website www.shoalhaven.nsw.gov.au and follow the links from the Planning and Development dropdown menu. A DA Guideline booklet and an Application Form can be viewed and downloaded.

In addition to the DA, it is also necessary to apply for a Construction Certificate (CC). The two applications can be made concurrently using the single DA form, or separately using each form as required. CCs can also be obtained from a private certifier. Application fees are based on the estimated contract price for the pool installation / construction. Quotations for fees can be obtained by contacting the Customer Service Counter staff.

More Information?

Written information can be viewed and downloaded as indicated in the website links, above, or contact Councils Customer Service Counter on 02-4429 3480.

Examples of Fencing Locations (source – Schedule 1 of the Swimming Pools Act 1992)

Diagram 1

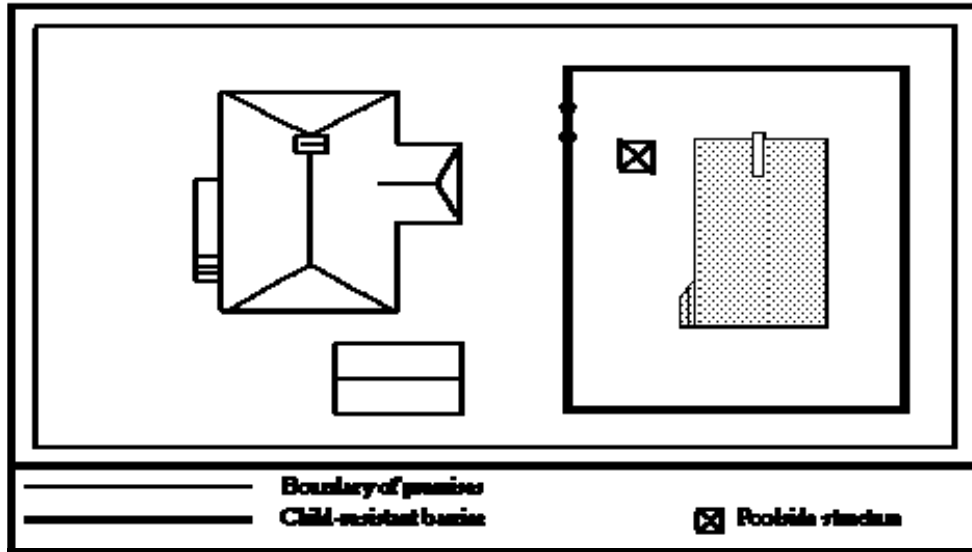

Diagram 2

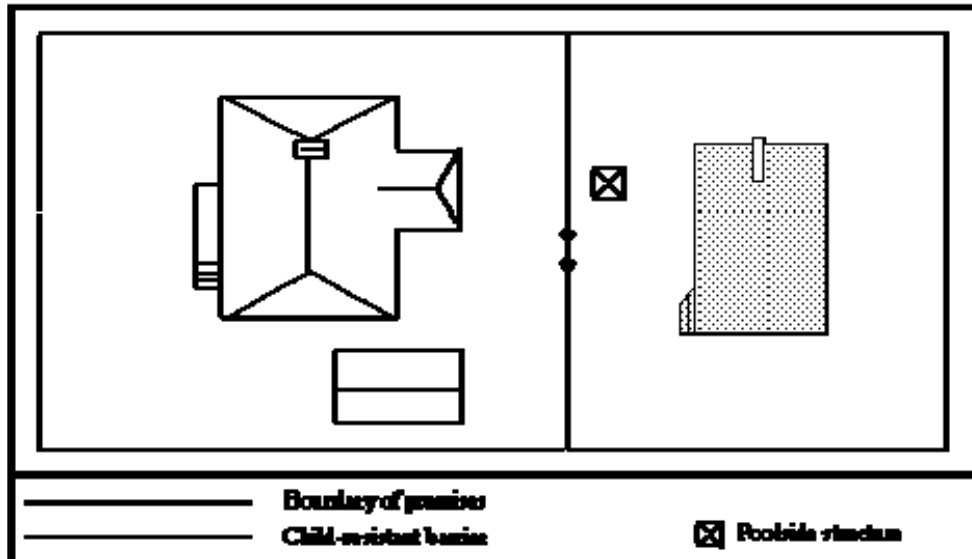

Diagram 3

